

EJ COMPANY

E J Company, Inc.
400 Bryan Lane
Woodbury, TN 37190

Phone: 615-563-5043
615-563-5010
Fax: 615-563-5122

sales@ejcompany.com

www.ejcompany.com

EJ COMPANY, INC.

on the cutting **EdJe** of performance

EJ SINGLE-FLUTE, BRAZED TIP GUNDRILLS

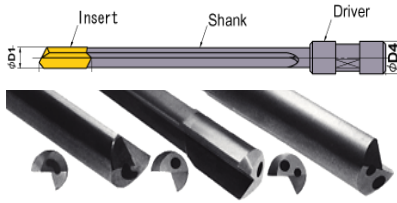

1/16" to 1-3/8" diameter

Standard lengths up to 48"
(special lengths on request)

CARBIDE INSERTS INDUSTRY STANDARDS & MADE-TO-PRINT SPECIALS



MILLING TURNING
GROOVING THREADING

RECONDITIONING SERVICES: (HIGH-PERFORMANCE CUTTING TOOLS)

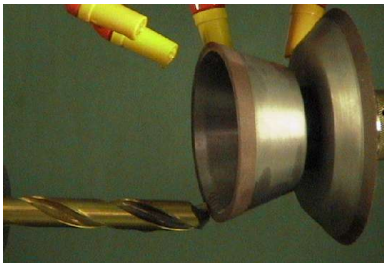

CNC RE-GRINDING OF TODAY'S HIGH-PERFORMANCE
DRILLS, END MILLS, SPECIAL CUTTERS, ETC...



END MILLS:
ROUGHERS
FINISHERS
BALLNOSE
CORNER RADII

DRILLS:
CARBIDE
CARBIDE-TIP
STEP DRILLS
GUNDRILLS

EJ (424.6) DOUBLE-TUBE STYLE

DEEP-HOLE DRILLS RANGE = .724" - 2.559"

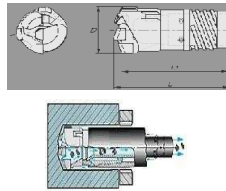

EJ (420.6) SINGLE-TUBE STYLE

DEEP-HOLE DRILLS RANGE = .312" - 2.559"

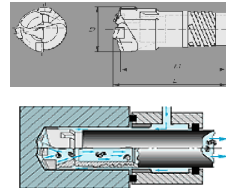

PERFORMANCE ENHANCING COATINGS:

TiN

TiCN

TiAlN

Multi-Layer
specials

EJ COMPANY, INC.
400 BRYANT LANE
WOODBURY, TN 37190
ph: 615-563-5043
fax: 615-563-5122
e-mail: sales@ejcompany.com

EJ COMPANY, INC.

on the cutting **EdJe** of performance

EJ (420.6) SINGLE TUBE STYLE DEEP-HOLE DRILLS RANGE = .312" - 2.559"

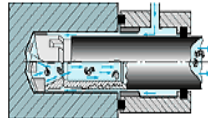
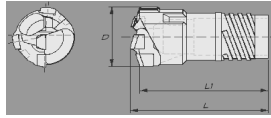

EJ Single-Tube drills and tubes are designed to deliver optimum performance and are interchangeable with existing, industry-standard single-tube systems.

DRILL DIAMETER (INCHES)	PRODUCT ORDERING CODE	DIMENSIONAL REFERENCES (INCH)		TUBE * -2 (63") * -4 (102")	CROSS-HOLE ADAPTER ADVISE DIA.
		"L"	"L1"		
.312-.354	EJ420.6-891ST	1.438	1.338	EJ420.5-789	EJ420.6-89CHA
.355-.393	EJ420.6-901ST	1.438	1.338	EJ420.5-790	EJ420.6-90CHA
.394-.432	EJ420.6-911ST	1.438	1.338	EJ420.5-791	EJ420.6-91CHA
.433-.472	EJ420.6-921ST	1.438	1.338	EJ420.5-792	EJ420.6-92CHA
.473-.495	EJ420.6-931ST	1.438	1.338	EJ420.5-793	EJ420.6-93CHA
.496-.515	EJ420.6-941	1.693	1.644	EJ420.5-794	EJ420.6-94CHA
.516-.535	EJ420.6-942	1.693	1.644	EJ420.5-794	EJ420.6-94CHA
.536-.555	EJ420.6-951	1.693	1.644	EJ420.5-795	EJ420.6-95CHA
.556-.575	EJ420.6-952	1.693	1.644	EJ420.5-795	EJ420.6-95CHA
.576-.594	EJ420.6-961	1.693	1.644	EJ420.5-796	EJ420.6-96CHA
.595-.614	EJ420.6-962	1.693	1.644	EJ420.5-796	EJ420.6-96CHA
.615-.637	EJ420.6-971	1.693	1.644	EJ420.5-797	EJ420.6-97CHA
.638-.657	EJ420.6-972	1.693	1.644	EJ420.5-797	EJ420.6-97CHA
.658-.677	EJ420.6-981	1.693	1.644	EJ420.5-798	EJ420.6-98CHA
.678-.696	EJ420.6-982	1.693	1.644	EJ420.5-798	EJ420.6-98CHA
.697-.724	EJ420.6-991	1.850	1.740	EJ420.5-799	EJ420.6-99CHA
.725-.744	EJ420.6-992	1.850	1.740	EJ420.5-799	EJ420.6-99CHA
.745-.755	EJ420.6-001	1.850	1.740	EJ420.5-800	EJ420.6-00CHA
.756-.787	EJ420.6-002	1.850	1.740	EJ420.5-800	EJ420.6-00CHA
.788-.822	EJ420.6-011	2.067	1.945	EJ420.5-801	EJ420.6-01CHA
.823-.858	EJ420.6-012	2.067	1.945	EJ420.5-801	EJ420.6-01CHA
.859-.901	EJ420.6-021	2.205	2.079	EJ420.5-802	EJ420.6-02CHA
.902-.948	EJ420.6-022	2.205	2.079	EJ420.5-802	EJ420.6-02CHA
.949-.992	EJ420.6-031	2.264	2.126	EJ420.5-803	EJ420.6-03CHA
.993-1.039	EJ420.6-032	2.264	2.126	EJ420.5-803	EJ420.6-03CHA
1.040-1.082	EJ420.6-041	2.264	2.126	EJ420.5-804	EJ420.6-04CHA
1.083-1.129	EJ420.6-042	2.264	2.126	EJ420.5-804	EJ420.6-04CHA
1.130-1.173	EJ420.6-051	2.500	2.343	EJ420.5-805	EJ420.6-05CHA
1.174-1.220	EJ420.6-052	2.500	2.343	EJ420.5-805	EJ420.6-05CHA
1.221-1.263	EJ420.6-061	2.500	2.343	EJ420.5-806	EJ420.6-06CHA
1.264-1.311	EJ420.6-062	2.500	2.343	EJ420.5-806	EJ420.6-06CHA
1.312-1.370	EJ420.6-071	2.500	2.323	EJ420.5-807	EJ420.6-07CHA
1.371-1.425	EJ420.6-072	2.500	2.323	EJ420.5-807	EJ420.6-07CHA
1.426-1.468	EJ420.6-081	2.894	2.695	EJ420.5-808	EJ420.6-08CHA
1.469-1.511	EJ420.6-082	2.894	2.695	EJ420.5-808	EJ420.6-08CHA
1.512-1.559	EJ420.6-083	2.894	2.695	EJ420.5-808	EJ420.6-08CHA
1.560-1.598	EJ420.6-091	2.894	2.695	EJ420.5-809	EJ420.6-09CHA
1.599-1.645	EJ420.6-092	2.894	2.695	EJ420.5-809	EJ420.6-09CHA
1.646-1.692	EJ420.6-093	2.894	2.695	EJ420.5-809	EJ420.6-09CHA
1.693-1.744	EJ420.6-101	2.953	2.725	EJ420.5-810	EJ420.6-10CHA
1.745-1.795	EJ420.6-102	2.953	2.725	EJ420.5-810	EJ420.6-10CHA
1.796-1.850	EJ420.6-103	2.953	2.725	EJ420.5-810	EJ420.6-10CHA
1.851-1.909	EJ420.6-111	2.953	2.725	EJ420.5-811	EJ420.6-11CHA
1.910-1.972	EJ420.6-112	2.953	2.725	EJ420.5-811	EJ420.6-11CHA
1.973-2.035	EJ420.6-113	2.953	2.725	EJ420.5-811	EJ420.6-11CHA
2.036-2.094	EJ420.6-121	3.228	2.961	EJ420.5-812	EJ420.6-12CHA
2.095-2.153	EJ420.6-122	3.228	2.961	EJ420.5-812	EJ420.6-12CHA
2.154-2.212	EJ420.6-123	3.228	2.961	EJ420.5-812	EJ420.6-12CHA
2.213-2.299	EJ420.6-131	3.307	2.039	EJ420.5-813	EJ420.6-13CHA
2.300-2.385	EJ420.6-132	3.307	2.039	EJ420.5-813	EJ420.6-13CHA
* 2.386-2.472	EJ420.6-133	3.307	2.039	EJ420.5-813	EJ420.6-13CHA
* 2.473-2.559	EJ420.6-134	3.307	2.039	EJ420.5-813	EJ420.6-13CHA

Special tube lengths are available upon request and are subject to quote.

ORDER EXAMPLES:	
DRILL:	EJ420.6-082 G2 D1.500"
TUBE:	EJ420.5-808-4
CROSS-HOLE:	EJ420.6-08CH D1.496"

STANDARD GRADES (UNCOATED & COATED)			
G2 (C5)	G210(TiN)	G250(TiCN)	G270(TiAlN)
G3 (C5)	G310(TiN)	G350(TiCN)	G370(TiAlN)
G4 (C2)	G410(TiN)	G450(TiCN)	G470(TiAlN)
G9 (C7)	G910(TiN)	G950(TiCN)	G970(TiAlN)
G22 (C6)	G2210(TiN)	G2250(TiCN)	G2270(TiAlN)
* Other grades available upon request. *			

EJ Company, Inc.
400 Bryant Lane
Woodbury, TN 37190
ph: 615-563-5043
fax: 615-563-5122
e-mail: sales@ejcompany.com

* EJ420.5-813E TUBES MAY BE USED FOR THESE DIAMETERS FOR INCREASED RIGIDITY.

EJ COMPANY, INC.

on the cutting **E_dJ_e** of performance

EJ (424.6) DOUBLE TUBE STYLE DEEP-HOLE DRILLS RANGE = .724" - 2.559"

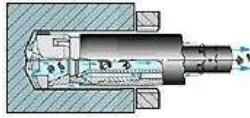
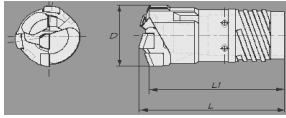

EJ Double-Tube drills and tubes are designed to deliver optimum performance and are interchangeable with existing, industry-standard double-tube systems.

DRILL DIAMETER (INCHES)	PRODUCT CODING CODE	DIMENSIONAL REFERENCES (INCH)		OUTER TUBE	INNER TUBE
		"L"	"L1"	* -2 (15.75") * -3 (24.80") * -4 (42.13")	* -2 (16.93") * -3 (25.98") * -4 (43.31")
.724-.756	EJ424.6-001	1.969	1.850	EJ424.2-800-	EJ424.2-850-
.757-.786	EJ424.6-002	1.969	1.850	EJ424.2-800-	EJ424.2-850-
.787-.822	EJ424.6-011	2.205	2.080	EJ424.2-801-	EJ424.2-851-
.823-.858	EJ424.6-012	2.205	2.080	EJ424.2-801-	EJ424.2-851-
.859-.902	EJ424.6-021	2.205	2.080	EJ424.2-802-	EJ424.2-852-
.903-.949	EJ424.6-022	2.205	2.080	EJ424.2-802-	EJ424.2-852-
.950-.992	EJ424.6-031	2.264	2.126	EJ424.2-803-	EJ424.2-853-
.993-1.039	EJ424.6-032	2.264	2.126	EJ424.2-803-	EJ424.2-853-
1.040-1.083	EJ424.6-041	2.382	2.236	EJ424.2-804-	EJ424.2-854-
1.084-1.130	EJ424.6-042	2.382	2.236	EJ424.2-804-	EJ424.2-854-
1.131-1.173	EJ424.6-051	2.500	2.340	EJ424.2-805-	EJ424.2-855-
1.174-1.220	EJ424.6-052	2.500	2.340	EJ424.2-805-	EJ424.2-855-
1.221-1.264	EJ424.6-061	2.500	2.340	EJ424.2-806-	EJ424.2-856-
1.265-1.311	EJ424.6-062	2.500	2.340	EJ424.2-806-	EJ424.2-856-
1.312-1.370	EJ424.6-071	2.776	2.598	EJ424.2-807-	EJ424.2-857-
1.371-1.425	EJ424.6-072	2.776	2.598	EJ424.2-807-	EJ424.2-857-
1.426-1.469	EJ424.6-081	2.894	2.700	EJ424.2-808-	EJ424.2-858-
1.470-1.512	EJ424.6-082	2.894	2.700	EJ424.2-808-	EJ424.2-858-
1.513-1.559	EJ424.6-083	2.894	2.700	EJ424.2-808-	EJ424.2-858-
1.560-1.598	EJ424.6-091	2.894	2.680	EJ424.2-809-	EJ424.2-859-
1.599-1.646	EJ424.6-092	2.894	2.680	EJ424.2-809-	EJ424.2-859-
1.647-1.693	EJ424.6-093	2.894	2.680	EJ424.2-809-	EJ424.2-859-
1.694-1.744	EJ424.6-101	2.953	2.730	EJ424.2-810-	EJ424.2-860-
1.745-1.795	EJ424.6-102	2.953	2.730	EJ424.2-810-	EJ424.2-860-
1.796-1.850	EJ424.6-103	2.953	2.730	EJ424.2-810-	EJ424.2-860-
1.851-1.909	EJ424.6-111	3.110	2.860	EJ424.2-811-	EJ424.2-861-
1.910-1.972	EJ424.6-112	3.110	2.860	EJ424.2-811-	EJ424.2-861-
1.973-2.035	EJ424.6-113	3.110	2.860	EJ424.2-811-	EJ424.2-861-
2.036-2.095	EJ424.6-121	3.228	2.965	EJ424.2-812-	EJ424.2-862-
2.096-2.154	EJ424.6-122	3.228	2.965	EJ424.2-812-	EJ424.2-862-
2.155-2.213	EJ424.6-123	3.228	2.965	EJ424.2-812-	EJ424.2-862-
2.214-2.299	EJ424.6-131	3.307	2.025	EJ424.2-813-	EJ424.2-863-
2.300-2.386	EJ424.6-132	3.307	2.025	EJ424.2-813-	EJ424.2-863-
2.387-2.472	EJ424.6-133	3.307	2.025	EJ424.2-813-	EJ424.2-863-
2.473-2.559	EJ424.6-134	3.307	2.025	EJ424.2-813-	EJ424.2-863-

Special tube lengths are available upon request and are subject to quote.

STANDARD GRADES (UNCOATED & COATED)				ORDER EXAMPLES:
G2 (C5)	G210(TiN)	G250(TiCN)	G270(TiAlN)	DRILL: EJ424.6-082 G2 D1.500
G3 (C5)	G310(TiN)	G350(TiCN)	G370(TiAlN)	OUTER TUBE: EJ424.2-808-4
G4 (C2)	G410(TiN)	G450(TiCN)	G470(TiAlN)	INNER TUBE: EJ424.2-858-4
G9 (C7)	G910(TiN)	G950(TiCN)	G970(TiAlN)	
G22 (C6)	G2210(TiN)	G2250(TiCN)	G2270(TiAlN)	

* Other grades available upon request. *

EJ Company, Inc.
400 Bryant Lane
Woodbury, TN 37190
ph: 615-563-5043
fax: 615-563-5122
e-mail: sales@ejcompany.com

EJ COMPANY, INC.

on the cutting EdJe of performance

EJ SINGLE-FLUTE, BRAZED TIP GUNDRILLS

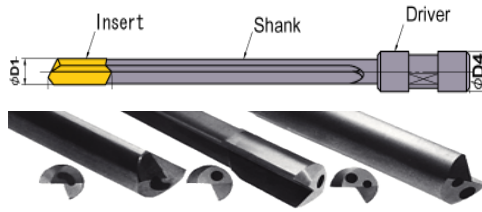

"KH"
KIDNEY
SHAPE
HOLE

"SH"
SINGLE
ROUND
HOLE

"DRH"
DOUBLE
ROUND
HOLE

CUSTOMER REQUIREMENTS
SINGLE FLUTE
KIDNEY HOLE
.500" DIAMETER
36" O'AL LENGTH
ORDER EXAMPLE: EJ-SF-KH-D0.500"-L36"

SINGLE-FLUTE GUNDRILLS:

1/16" to 1-3/8" diameter.

Standard lengths up to 48"
(special lengths on request)

Coating available upon request.

EJ Gundrills are precision built and ground using our automated processes. All drills are ground on specially adapted CNC equipment, insuring repeatability, thus producing accurate holes with excellent surface finishes. Drills are manufactured of highest quality materials and carbides with kidney shape, single round, and double round coolant holes. Drills can be manufactured to "Special" point geometry as well as various standard point geometries offered by EJ Company.

EJ Company, Inc.
400 Bryant Lane
Woodbury, TN 37190
ph: 615-563-5043
fax: 615-563-5122
e-mail: sales@ejcompany.com

EJ COMPANY, INC.

on the cutting EdJe of performance

CARBIDE INSERTS: (INDUSTRY STANDARDS & MADE-TO-PRINT SPECIALS)



EJ Company is an industry leader in the field of carbide inserts manufacturing. Our long history, experience, and knowledge of the ever-changing field of carbide inserts, make us uniquely capable of addressing your requirements.

We are specialists in manufacturing "Special, Made-to-Print" inserts.

We also offer a full range of today's industry standards such as: on-edge, lay-down, v-bottom, top-notch, etc... All inserts are available in a variety of grades, both uncoated or with the latest performance-enhancing coatings.

Milling

Turning

Grooving

Threading

EJ Company, Inc.
400 Bryant Lane
Woodbury, TN 37190
ph: 615-563-5043
fax: 615-563-5122
e-mail: sales@ejcompany.com

EJ COMPANY, INC.

on the cutting **EdJe** of performance

RECONDITIONING SERVICES (HIGH-PERFORMANCE CUTTING TOOLS)

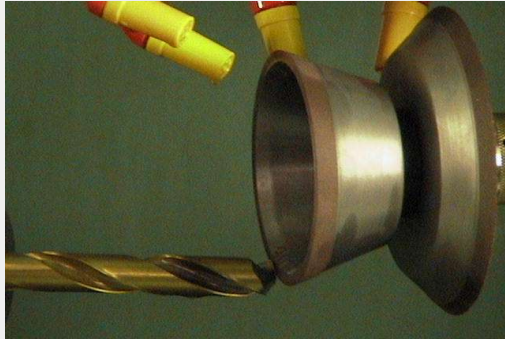

CNC RE-GRINDING OF TODAY'S HIGH-PERFORMANCE
DRILLS, END MILLS, SPECIAL CUTTERS, ETC...

RESHARPEN

RETIP

RE-COAT

!! ACHIEVE "LIKE-NEW" PERFORMANCE @ A FRACTION OF THE COST !!

(QUALITY) (CONSISTENCY) (TIMELY TURNAROUND)

RECONDITION AND RE-COAT WITH ONE
OUR PERFORMANCE-ENHANCING COATINGS.

TiN

TiCN

TiAlN

? OR ONE OF OUR MULTI-LAYER EXOTIC COATINGS ?

SEE HOW WE CAN HELP IMPROVE YOUR BOTTOM LINE...

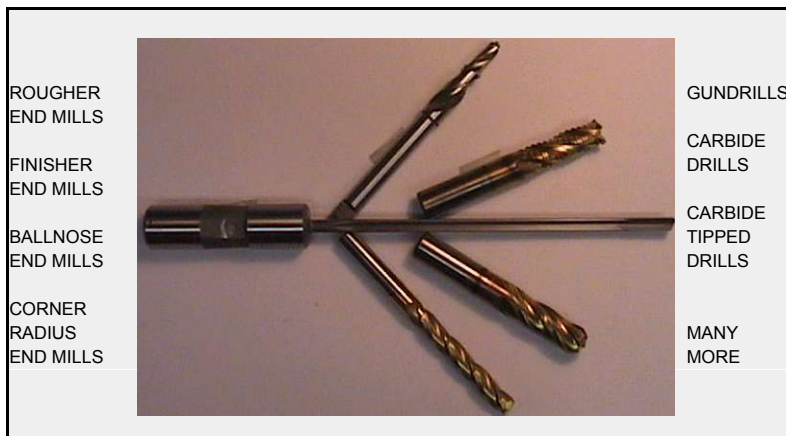

EJ Company, Inc.
400 Bryant Lane
Woodbury, TN 37190
ph: 615-563-5043
fax: 615-563-5122
e-mail: sales@ejcompany.com